

L3 - C

Carlaw Park

AVAILABLE

Now

OVERVIEW

Open plan office on the top floor

FEATURES

- Walkway from Parnell Train Station
- Total floor area 547sqm
- Tenant fitout plan available

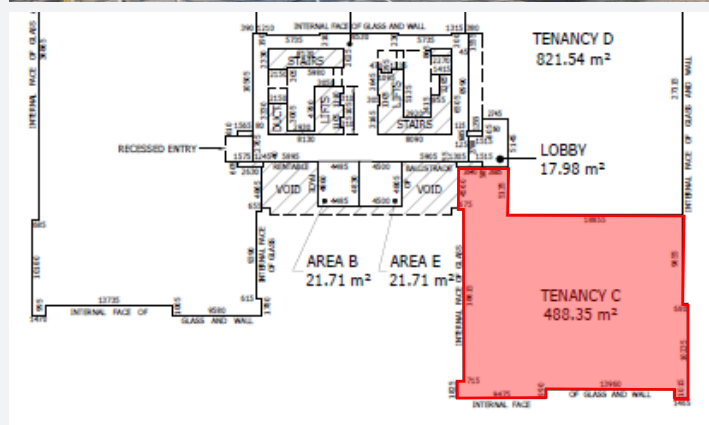
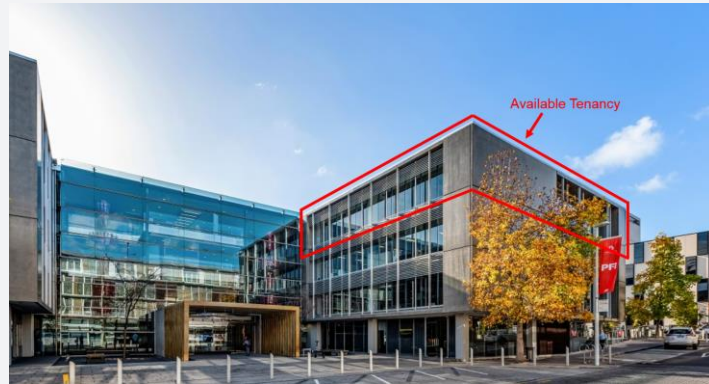

Ewan Cameron
 Portfolio Manager
 +6421 287 7990
cameron@pfi.co.nz

Jodie Warman
 Asset Manager
 +6421 932 424
warman@pfi.co.nz



Carlaw Park, 15 Nicholls Lane, Auckland CBD, Auckland 1010



<https://www.propertyforindustry.co.nz/about-pfi-tenant/property-portfolio/property/40>

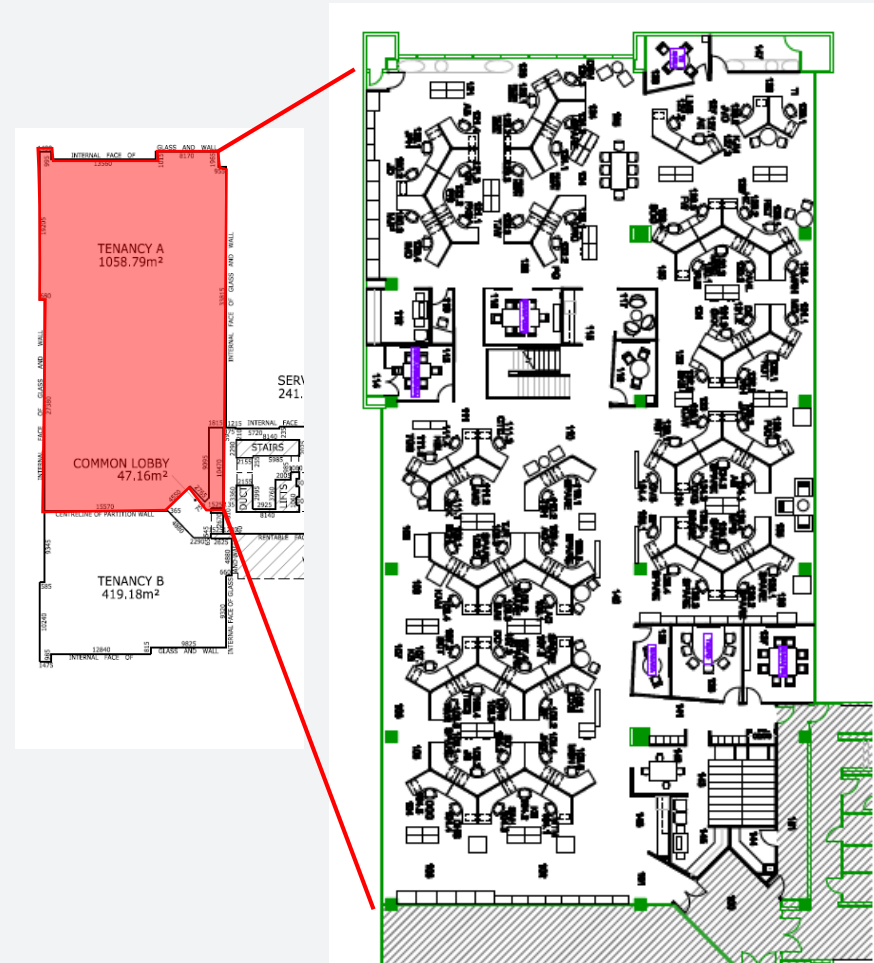

L1 - A

Carlaw Park

AVAILABLE

September 2020

OVERVIEW

Large open plan office space in sought after Carlaw Park

FEATURES

- 4-Star Green Rated Office Building
- 1,184sqm over level 1 available from September-20
- Can retain some or all of existing tenant fit-out or take as open plan

Ewan Cameron
Portfolio Manager
+6421 287 7990
cameron@pfi.co.nz

Jodie Warman
Asset Manager
+6421 932 424
warman@pfi.co.nz